

**INSTRUCTION  
MANUAL**

**SPECIFICATION**

**LITHIUM-ION POLYMER POWER BANK**

Capacity: 5000mAh / 18.5Wh  
Input: 5V=2.0A  
Output: 5V=2.0A  
Total Output: 10W (Max)  
Size: 82.5mm X18.25mm X 109mm / 129g

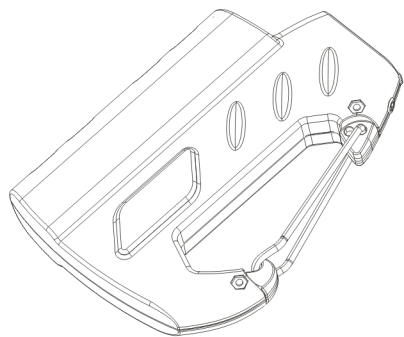

**SPECIFICATION**

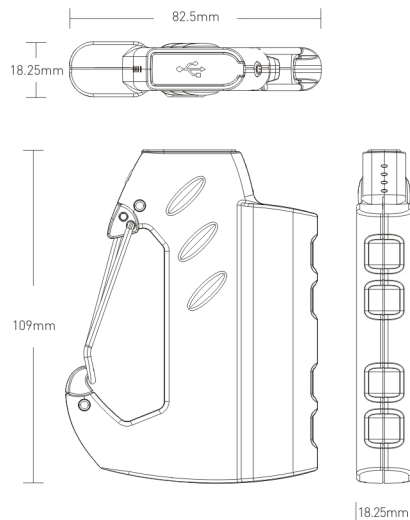

**FUNCTION DESCRIPTION**

Charging for iPod, iPhone, iPad, Smartphone & Tablet or any other devices.

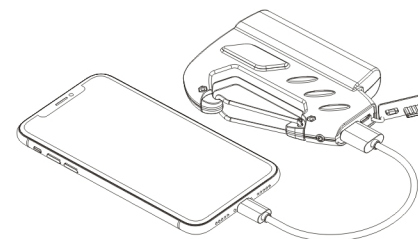

**FUNCTION DESCRIPTION**

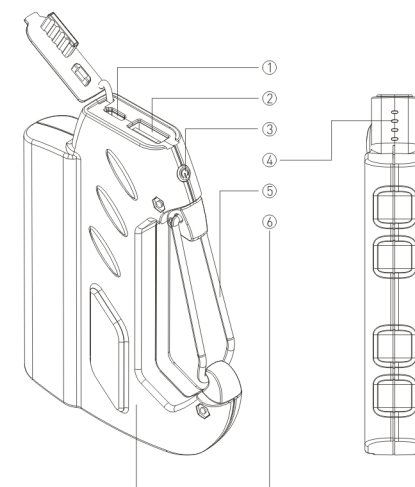

- ① Charging Port (Micro)
- ② Discharging Port (USB-A)
- ③ On/Off Button
- ④ LED Indicator
- ⑤ Carabiner
- ⑥ Fire-retardant Shell

**USAGE**

**Charging for mobile devices:**

- Use self-contained cable with Micro interface to charge for the device.

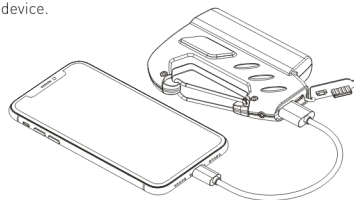

**Charging for power bank:**

- Connecting self-contained cable with AC adapter or USB port of computer can charge for this power bank.

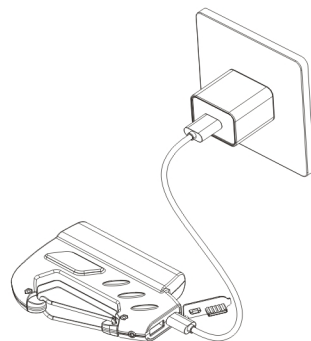

**USAGE**



- Press slightly to turn on.

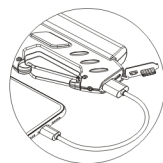

- This product has automatic start up function when inserted into the device.

**POWER DISPLAY**

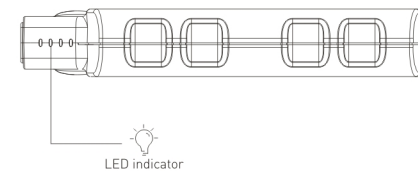

Indicator	Battery Level
4 LED ON	>75%
3 LED ON	>50%
2 LED ON	>25%
1 LED ON	>10%
1 LED Flashing	<10%

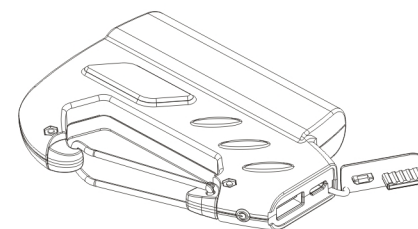

**SAFETY RULES**

1. This power bank adapts high quality polymer battery and you can use it at ease.
2. Don't throw and separate it or impale the power bank by yourself; be sure not to expose the battery into fire, high temperature or water and so on; it's suggested that user should use power adapter which comes with phone or standard brand for it. If there are any ballooning, weeping, other improper phenomenon of power bank or the mobile device being charged, please stop using.
3. In the process of charging or discharging, the product has proper heating phenomenon; the heating temperature is below 40°C and without influencing products performance. User can use it at ease.
4. Please charge full electricity to it before first time to use; the product can achieve ideal state after 3 to 5 times of discharging circulation.

**WARNING** Please follow the above safety instructions otherwise it will cause fire, electric shock, damage or other accident.

**TIPS**

1. Power bank capacity is not equivalent to the rechargeable amount due to the conversion efficiency of power bank.
2. Please charge your energy regularly (at least once every 5 months is recommended) to maintain its long service life.
3. Improper use of the product is likely to damage the product itself or may endanger personal and property safety.
4. If the consumer violates the product specification or warning and makes inappropriate use, the resulting personal and property loss should be taken by the consumer. Our company will not take any legal responsibility.

